

REVISIONS					
ECN	REV	DESCRIPTION	ZONE	BY	DATE
27701	A	NEW RELEASE		JDS	12/2/2022
30153	B	UPDATE ADAPTERS, ADD MANIFOLD	D2, D3, E3, E6, F6	JDS	2/15/2024
30511	C	UPDATE ADAPTERS	D4, E7	JDS	4/30/2024
30959	D	UPDATE ADAPTERS	E6	JDS	9/6/2024
31351	E	ADD (2) 1030263-D-180S-M10 UPDATE HARDWARE	C7, D7	JDO	11/6/2024
31531	F	1031019 REPLACED 1023693	E3, F7	DEG	2/3/2025
31750	G	REPLACE (4) 100-6-16-24-5 WITH 100-6-16-20-5	D7	TWJ	2/5/2025
32229	H	UPDATE ADAPTERS USED IN 900140 FROM -6 TO -4	D3	TWJ	4/21/2025

ITEM NO.	PART NUMBER	QTY	DESCRIPTION
1	1027170	1	WELDMENT, HYDRAULIC TANK, 8680
2	1014037	2	STRAINER, SUCTION, 100 MESH, O-RING SEAL
3	1014025	1	STRAINER,SUCTION, 75 GPM, 100 MESH
4	1011971	1	PLUG, MAGNETIC DRAIN, -16 SAE ORB
5	140030HL	1	CAP, HYDRAULIC, LOCKABLE
6	140030FN	1	FILLER NECK
7	140030GK	1	STRAINER & GASKET KIT, HYDRAULIC/FUEL
8	1022208	1	RETURN FILTER, INTANK, 119 GPM
9	2503-40-40	1	ADAPTER, ELBOW, 45 deg, -40 JIC X -40 NPTF
10	989202	1	SENSOR, TEMPERATURE, HYDRAULIC
11	500070	1	GAUGE, SIGHT LEVEL/TEMP, HYD OIL
12	FS6400-24-24-O	1	ADAPTER, STRAIGHT, -24 ORFS / -24 O-RING
13	FS6801-16-20-NWO-FG	3	ADAPTER, ELBOW, 90 deg, -16 ORFS / -20 O-RING
14	FS6801-10-10-NWO-FG	2	ADAPTER, ELBOW, 90 deg, -10 ORFS / -10 O-RING
15	FS6801-08-10-NWO-FG	1	ADAPTER, ELBOW, 90 deg, -8 ORFS / -10 O-RING
16	FS6801-06-08-NWO-FG	1	ADAPTER, ELBOW, 90 deg, -6 ORFS / -8 O-RING
17	1031019	1	ASSEMBLY, CHARGE FILTER WITH ADAPTERS, ORFS, 8680
18	900140	1	VALVE, SOLENOID, 2 SPEED
19	FS6400-06-10-O	1	ADAPTER, STRAIGHT, -6 ORFS / -10 O-RING
20	FS6540-06-06-O	1	ADAPTER, STRAIGHT SWIVEL, -6 ORFS / -6 O-RING
21	FS6801-04-06-NWO-FG	1	ADAPTER, ELBOW, 90 deg, -4 ORFS / -6 O-RING
22	FS6400-04-06-O	1	ADAPTER, STRAIGHT, -4 ORFS / -6 O-RING
23	FS6564-10-10-04	1	ADAPTER, TEST PORT, -10 ORFS / -10 ORFS / -4 O-RING
24	FS6801-04-04-NWO-FG	1	ADAPTER, ELBOW, 90 deg, -4 ORFS / -4 O-RING
25	1030263-D-180S-M10	2	CLAMP, P RATCHET, 180° TAB SHORT, 1.42-2.00, M10
26	122-#10-24-8F	6	PHMS, CROSS, #10-24 X 0.5, FT
27	100-6-16-20-5	4	CSHH,3/8-16 X 1.25,GR5
28	302-6	10	WASHER, LOCK, 3/8
29	300-6	10	WASHER, FLAT, SAE, 3/8
30	100-6-16-16-5F	4	CSHH,3/8-16 X 1,GR5,FT
31	100-6-24-8-5F	2	CSHH,3/8-24 X 0.5,GR5,FT

INSTALL STAUFF CLOG INDICATOR ON SIDE SHOWN. APPLY SEALANT TO NPT PLUG ON OPPOSITE SIDE

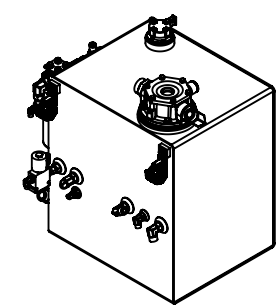
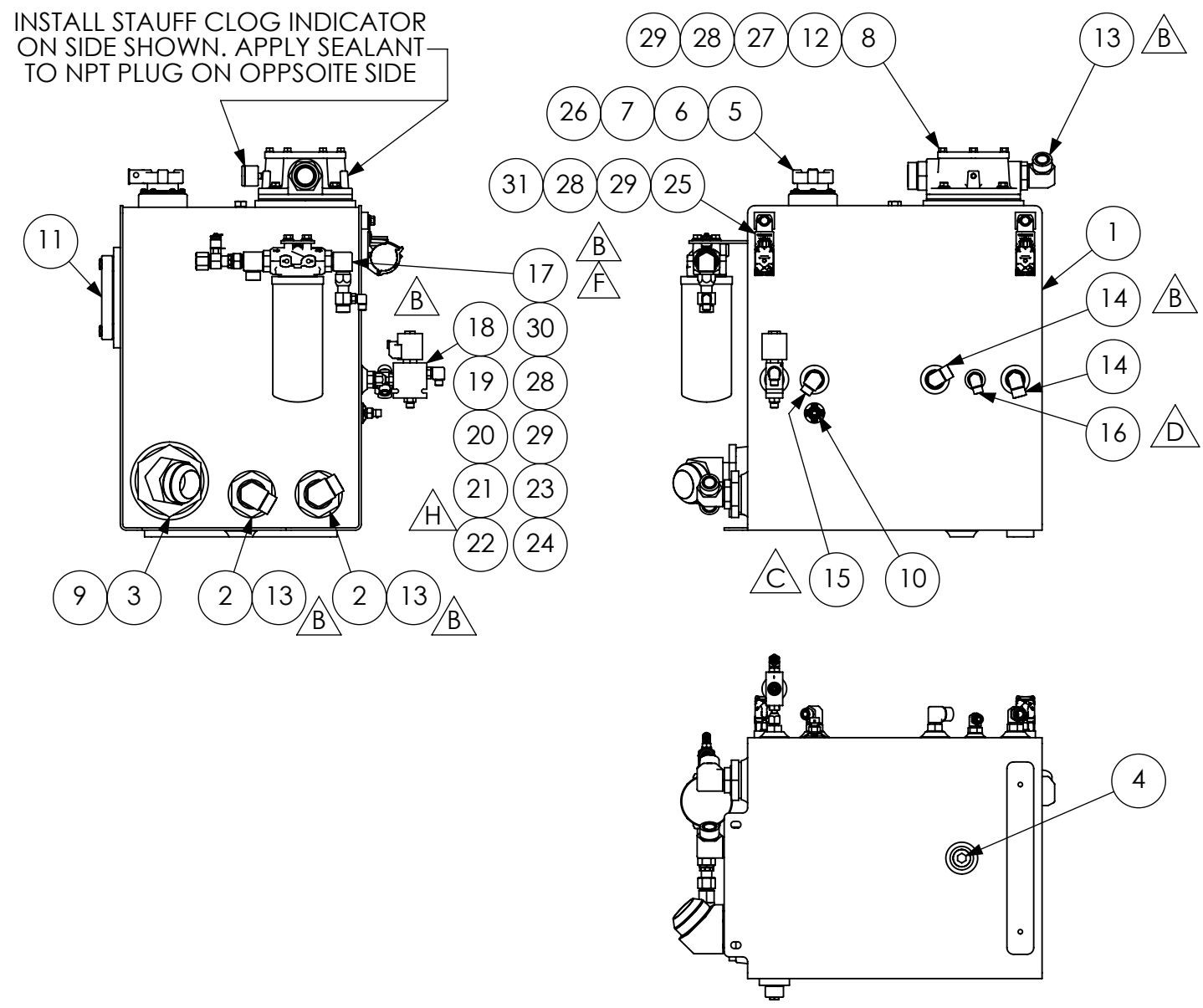

NOTES:  
1.

FINISH PER LEEBOY SPECIFICATION DRAWING 1014877													DIMENSIONS ARE IN INCHES UNLESS OTHERWISE SPECIFIED		APPROVALS		DATE		<b>1027177</b>	
GENERAL FABRICATION TOLERANCE - INCH													DIMENSIONS APPLY TO FINISHED PART. ROUGH CUTS MUST INCLUDE APPROPRIATE STOCK ALLOWANCE FOR MACHINED PARTS.		DRAWN BY JDS		11/21/2022		ASSEMBLY, HYDRAULIC TANK, 8680	
SURFACE: 250													(REFERENCE DIMENSIONS)		CHECKED BY TWJ		04/21/2025			
GENERAL MACHINING TOLERANCE													REFER TO TABLES FOR GENERAL TOLERANCES		INFORMATION CONTAINED ON THIS DRAWING IS THE SOLE PROPERTY OF LEEBOY. ANY REPRODUCTION IN PART OR WHOLE WITHOUT THE WRITTEN PERMISSION OF LEEBOY IS PROHIBITED.					
SURFACE: 125													SHEET SCALE: 1:12						THIRD ANGLE PROJECTION	
>	0.000	3.000	12.000	24.000	48.000	96.000	120.000	240.000	0.000	1.000	3.000	6.000	12.000	36.000	PAVER / MULTIPLE					
≤	3.000	12.000	24.000	48.000	96.000	120.000	240.000	~	1.000	3.000	6.000	12.000	36.000	SHT 1 OF 1					PART WEIGHT: 200.90 LBS	
±	0.015	0.031	0.063	0.094	0.125	0.188	0.250	0.500	0.005	0.010	0.015	0.031	0.063	0.094	REV		<b>H</b>			
ANGLE	±0.5°		±1.0°		±2.0°		±3.0°		±0.1°		±0.3°		±0.5°							

